

**Bijlage bij het BENOR productcertificaat nr. 270/2004/0004 uitgereikt op 6.03.2025.****Productie-eenheid:**

Conares Metal Supply Limited
16, S1000, Jafza, PO Box 2854
Dubai

Telefoon: +971/48835111
Fax: +971/48836611
E-mail: amit.singh@conares.com

Walsmerk: 0/9/5/6**Producten:**

**GEWALST BE 500 S
STAVEN
Diameters 8 - 50 mm**

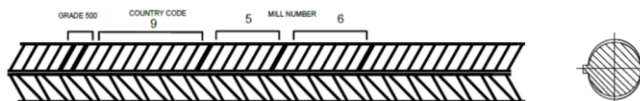
**Verkoopkantoor:**

Conares Metal Supply Limited
16, S1000, Jafza, PO Box 2854
Dubai

Telefoon: +971/48835111, Fax: +971/48836611,
E-mail: amit.singh@conares.com

**Annexe au certificat produit BENOR no. 270/2004/0004 délivré le 6.03.2025.****Unité de production:**

Conares Metal Supply Limited
16, S1000, Jafza, PO Box 2854
Dubai

Téléphone: +971/48835111
Fax: +971/48836611
E-mail: amit.singh@conares.com

Marque de laminage: 0/9/5/6**Produits:**

LAMINE BE 500 S
BARRES
Diamètres 8 - 50 mm

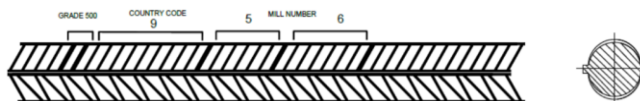
**Organisme de vente:**

Conares Metal Supply Limited
16, S1000, Jafza, PO Box 2854
Dubai

Téléphone: +971/48835111, Fax:
+971/48836611, E-mail: amit.singh@conares.com

**Annex to the BENOR product certificate nr. 270/2004/0004 delivered on 6.03.2025.****Production unit:**

Conares Metal Supply Limited
16, S1000, Jafza, PO Box 2854
Dubai

Phone: +971/48835111
Fax: +971/48836611
E-mail: amit.singh@conares.com

Rolling mark: 0/9/5/6**Products:**

LAMINE BE 500 S
BARRES
Diamètres 8 - 50 mm

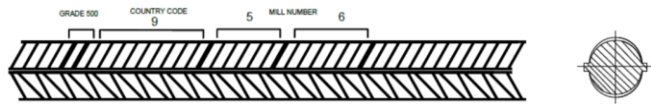
**Sales office:**

Conares Metal Supply Limited
16, S1000, Jafza, PO Box 2854
Dubai

Phone: +971/48835111, Fax: +971/48836611, E-mail: amit.singh@conares.com